

Ruote

I Ruote normali a 1 cuscinetto - gola V per **ANGULA**

- UK Normal wheel with one bearing - V groove
- D Laufrollen mit einem Lager - V Nut
- F Roues normales avec 1 roulement - gorge V
- E Ruedas normales con 1 cojinete - guía V
- RUS Ролик нормальный с 1 подшипником паз V

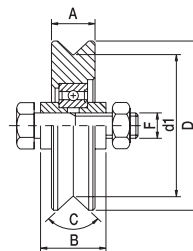

Articolo - Article		D	d1	A	B	C	F	LxHxS	Portata Capacity		
Riferimento - Reference		∅		mm		V	UNI	mm	⊕ x1	N°	⊕
518 V	RT 50 18 V1	50	39	18	24	96°	M 10x45	50x30x3	60	30	7,2
618 V	RT 60 18 V1	60	49	18	24	96°	M 10x45	60x30x3	80	30	10,2
718 V	RT 70 18 V1	70	59	18	24	96°	M 10x45	60x30x3	100	20	10
820 V	RT 80 20 V1	80	65	20	24	96°	M 12x50	80x30x3	140	20	13
920 V	RT 90 20 V1	90	75	20	24	96°	M 12x50	80x30x3	160	20	17
1020 V	RT 10 20 V1	100	85	20	34	96°	M 14x60	100x40x3	180	20	22,4
1220 V	RT 12 20 V1	120	105	20	34	96°	M 14x60	120x40x3	200	12	19,6
1420 V	RT 14 20 V1	140	125	20	34	96°	M 14x60	120x40x3	230	6	13,5
1620 V	RT 16 20 V1	160	145	20	34	96°	M 14x60	140x40x3	250	6	17,6

I Ruote normali a 1 cuscinetto - gola U

- UK Normal wheel with one bearing - U groove
- D Laufrollen mit einem Lager - U Nut
- F Roues normales avec 1 roulement - gorge U
- E Ruedas normales con 1 cojinete - guía U
- RUS Ролик нормальный с 1 подшипником паз U

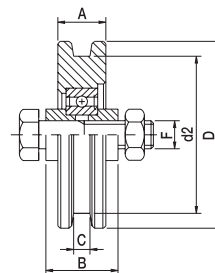

Articolo - Article		D	d2	A	B	C	F	LxHxS	Portata Capacity		
Riferimento - Reference		∅		mm		U	UNI	mm	⊕ x1	N°	⊕
618 U	RT 60 18 U1	60	49	18	24	7	M 10x45	60x30x3	80	30	10,2
718 U	RT 70 18 U1	70	59	18	24	7	M 10x45	60x30x3	100	20	10
820 U	RT 80 20 U1	80	65	20	24	7	M 12x50	80x30x3	100	20	12
920 U	RT 90 20 U1	90	75	20	24	7	M 12x50	80x30x3	160	20	16,5
1020 U	RT 10 20 U1	100	85	20	34	7	M 14x60	100x40x3	180	20	22,1
1220 U	RT 12 20 U1	120	105	20	34	7	M 14x60	120x40x3	200	12	19,1
1420 U	RT 14 20 U1	140	125	20	34	7	M 14x60	120x40x3	230	6	13,1
1620 U	RT 16 20 U1	160	145	20	34	7	M 14x60	140x40x3	250	6	17,7

I Ruote normali a 1 cuscinetto - gola O per **IBBI Ø16**

- UK Normal wheel with one bearing - O groove
- D Laufrollen mit einem Lager - O Nut
- F Roues normales avec 1 roulement - gorge O
- E Ruedas normales con 1 cojinete - guía O
- RUS Ролик нормальный с 1 подшипником паз O

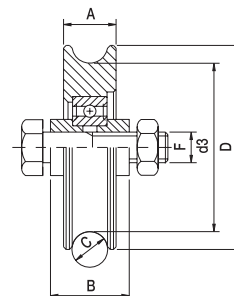

Articolo - Article		D	d3	A	B	C	F	LxHxS	Portata Capacity		
Riferimento - Reference		∅		mm		O	UNI	mm	⊕ x1	N°	⊕
827 O 16	RT 80 27 O16	80	61	26	34	16	M 14x60	80x40x3	120	20	15
1027 O 16	RT 10 27 O16	100	81	26	34	16	M 14x60	80x40x3	160	16	20,6
1227 O 16	RT 12 27 O16	120	101	26	34	16	M 14x60	80x40x3	180	10	19,3

I Ruote normali a 1 cuscinetto - gola O per

- UK Normal wheel with one bearing - O groove
- D Laufrollen mit einem Lager - O Nut
- F Roues normales avec 1 roulement - gorge O
- E Ruedas normales con 1 cojinete - guía O
- RUS Ролик нормальный с 1 подшипником паз O

NEW OMEGA NEW OMEGA 2
FLOOR HEAVY
IBBI SISTEMA

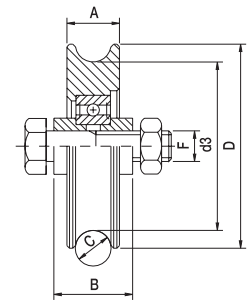

Articolo - Article		D	d3	A	B	C	F	LxHxS	Portata Capacity		
Riferimento - Reference		∅		mm		O	UNI	mm	⊕ x1	N°	⊕
827 O	RT 80 27 01	80	61	26	34	21	M 14x60	80x40x3	140	20	15
1027 O	RT 10 27 01	100	81	26	34	21	M 14x60	100x40x3	180	16	20,6
1227 O	RT 12 27 01	120	101	26	34	21	M 14x60	120x40x3	200	10	19,3

I Ruote normali a 2 cuscinetti - gola V per

- UK Normal wheels with two bearings - V groove
- D Laufrollen mit zwei Lagern - V Nut
- F Roues normales avec 2 roulements - gorge V
- E Ruedas normales con 2 cojinetes - guía V
- RUS Ролик нормальный с 2 подшипниками паз V

ANGULA

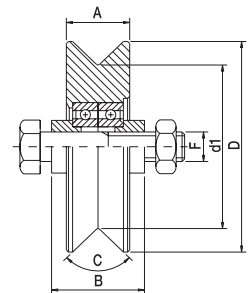

Articolo - Article		D	d1	A	B	C	F	LxHxS	Portata Capacity		
Riferimento - Reference		∅		mm		V	UNI	mm	⊕ x1	N°	⊕
1030 V	RT 10 30 V2	100	80	30	44	96°	M 14x70	100x50x3	300	12	16
1230 V	RT 12 30 V2	120	100	30	44	96°	M 14x70	120x50x3	350	8	17,5
1430 V	RT 14 30 V2	140	119	30	44	96°	M 14x70	140x50x3	400	4	12,7
1630 V	RT 16 30 V2	160	140	30	44	96°	M 14x70	160x50x3	440	4	17,1
1830 V	RT 18 30 V2	180	160	30	44	96°	M 14x70	180x50x3	470	4	21,9
2030 V	RT 20 30 V2	200	179	30	44	96°	M 14x70	200x50x3	500	4	27,2

I Ruote normali a 2 cuscinetti - gola U

- UK Normal wheels with two bearings - U groove
- D Laufrollen mit zwei Lagern - U Nut
- F Roues normales avec 2 roulements - gorge U
- E Ruedas normales con 2 cojinetes - guía U
- RUS Ролик нормальный с 2 подшипниками паз U

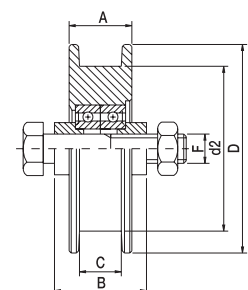

Articolo - Article		D	d2	A	B	C	F	LxHxS	Portata Capacity		
Riferimento - Reference		∅		mm		U	UNI	mm	⊕ x1	N°	⊕
1030 U	RT 10 30 U2	100	78	30	44	21	M 14x70	100x50x3	300	12	16,2
1230 U	RT 12 30 U2	120	100	30	44	21	M 14x70	120x50x3	350	8	16,9
1430 U	RT 14 30 U2	140	120	30	44	21	M 14x70	140x50x3	400	4	11,9
1630 U	RT 16 30 U2	160	140	30	44	21	M 14x70	160x50x3	440	4	15,9
1830 U	RT 18 30 U2	180	160	30	44	21	M 14x70	180x50x3	470	4	20,6
2030 U	RT 20 30 U2	200	180	30	44	21	M 14x70	200x50x3	500	4	25,8

I Ruote normali a 2 cuscinetti - gola O per

UK Normal wheels with two bearings - O groove

D Laufrollen mit zwei Lagern - O Nut

F Roues normales avec 2 roulements - gorge O

E Ruedas normales con 2 cojinetes - guía O

RUS Ролик нормальный с 2 подшипниками паз O

NEW OMEGA

NEW OMEGA 2

FLOOR

HEAVY

IBBI

SISTEMA

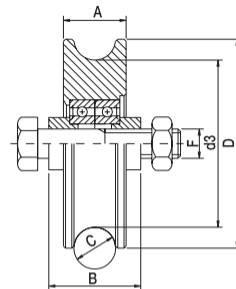

Articolo - Article		D	d3	A	B	C	F	LxHxS	Portata Capacity		
Riferimento - Reference		∅		mm		O	UNI	mm	kg x1	N°	kg
830 O	RT 80 30 02	80	60	30	44	21	M 14x70	80x50x3	250	12	14,5
1030 O	RT 10 30 02	100	80	30	44	21	M 14x70	100x50x3	300	12	17,9
1230 O	RT 12 30 02	120	100	30	44	21	M 14x70	120x50x3	350	8	17,8
1430 O	RT 14 30 02	140	120	30	44	21	M 14x70	140x50x3	400	4	12,5
1630 O	RT 16 30 02	160	140	30	44	21	M 14x70	160x50x3	440	4	16,7
1830 O	RT 18 30 02	180	160	30	44	21	M 14x70	180x50x3	470	4	21,4
2030 O	RT 20 30 02	200	180	30	44	21	M 14x70	200x50x3	500	4	26,7