



BIONIK

The BRUSHLESS
automated barrier
with digital thinking



Linkage lever and springs

Different types of spring are available, according to the length of the boom and certified for millions of manoeuvres. Mechanical linkage lever with adjustable mechanical stops.



LED lighting

Elegant LED lighting circuit all over the aluminium head of the barrier column. Can be configured via the control unit.



Absolute mechanical positioner

Powerful, innovative and accurate encoder with absolute positioning, mounted on the slow reducer shaft. Allows movements to be managed in tenths of a degree, and ensures perfect automation restart without relearning after the blackout or manual release phases.



Robust, elliptic boom

Aluminium boom with an elliptical section providing greater wind resistance, and central ribbing for even greater stability and robustness. Integrated signalisation LED on the upper side. Can be configured via the control unit.



Robust, innovative release

Mechanical manual release with standard cylinder lock, able to unlock the barrier in any situation thanks to its excellent mechanics based on a twin-acting elliptical lever.



Bionic boom support arm

Bionic support and protection arm in die-cast aluminium, directly connected to the reducer via a special system for pre-reducing the mechanical stress of the boom movement.



5

Linkage lever and springs

Different types of spring are available, according to the length of the boom and certified for millions of manoeuvres. Mechanical linkage lever with adjustable mechanical stops.

6

LED lighting

Elegant LED lighting circuit all over the aluminium head of the barrier column. Can be configured via the control unit.

7

Absolute mechanical positioner

Powerful, innovative and accurate encoder with absolute positioning, mounted on the slow reducer shaft. Allows movements to be managed in tenths of a degree, and ensures perfect automation restart without relearning after the blackout or manual release phases.

8

Robust, elliptic boom

Elliptical section, wind-resistant aluminium boom with central ribbing, to provide even greater stability and sturdiness. Signalisation LED on both horizontal ends of the boom, integrated and configurable from the control unit.

9

Robust, innovative release

Manual mechanical release by key, with European cylinder able to release the boom for any requirement and in any situation, thanks to its excellent mechanical features.

10

Sturdy boom support flange

Extended cone double flange in die-cast aluminium for support and protection, directly connected to the reduction gear with 3 internal flanges fastening system, for a sturdy and safe mechanical movement of the boom.

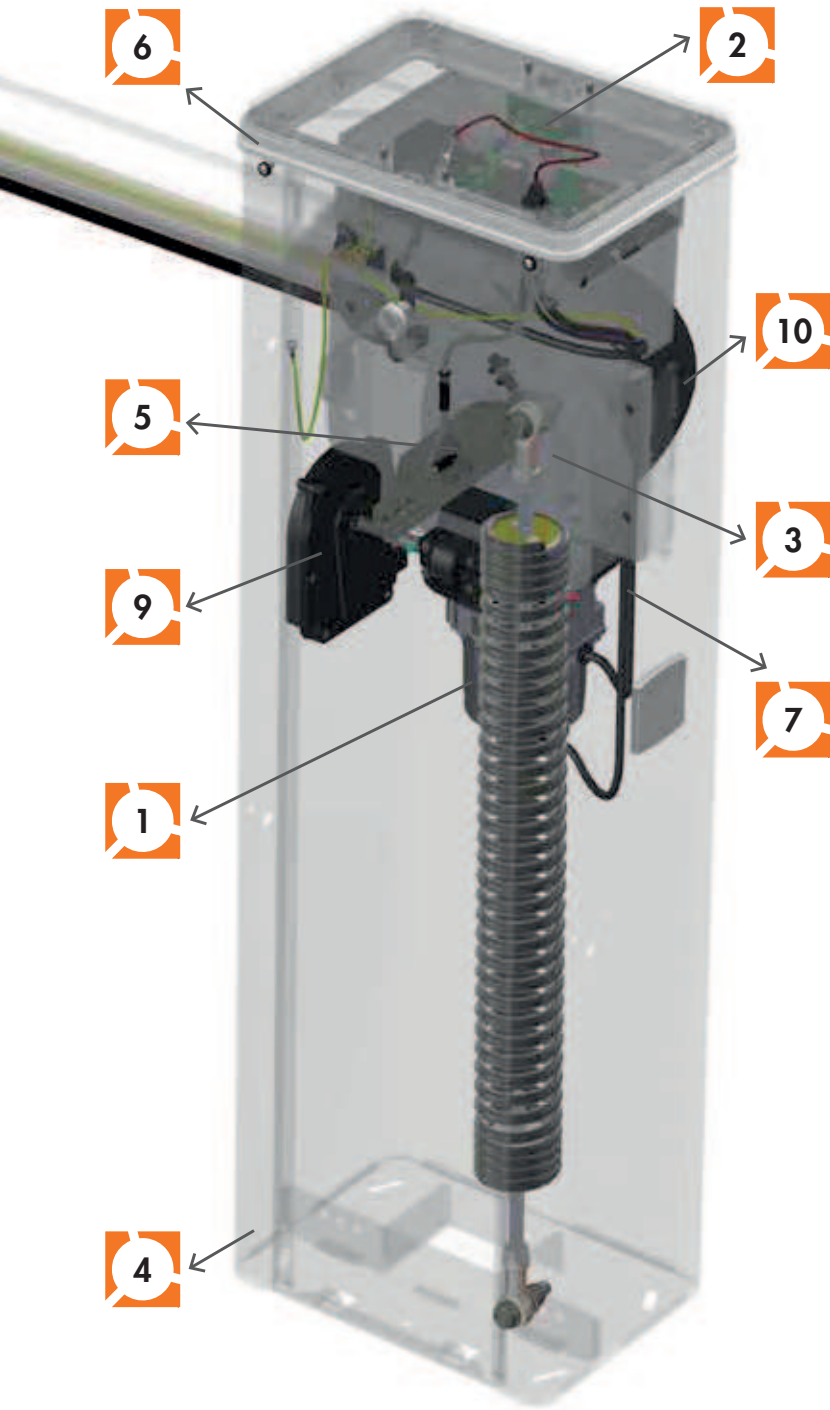

BARRIER AVAILABLE ALSO WITH BOOM LENGTH UP TO 4 M

BIONIK4HP

5

Sturdy boom support flange

Extended cone double flange in die-cast aluminium for support and protection, directly connected to the reduction gear for a sturdy and safe mechanical movement of the boom.

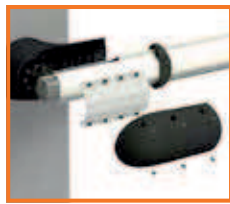

6

LED lighting

Elegant LED lighting circuit all over the aluminium head of the barrier column. Can be configured via the control unit.

7

Absolute mechanical positioner

Powerful, innovative and accurate encoder with absolute positioning, mounted on the slow reducer shaft. Allows movements to be managed in tenths of a degree, and ensures perfect automation restart without relearning after the blackout or manual release phases.

8

Robust, elliptic boom

Elliptical section 4,100 mm aluminium Double Boom, wind resistant, with 2 strengthening telescopic inserts to fasten the boom to the flange and to connect the 2 booms through a dedicated aluminium double joint. Integrated signalisation LED on the upper side, configurable from the control unit.

9

Robust, innovative release

Manual mechanical release by key, with European cylinder able to release the boom for any requirement and in any situation, thanks to its excellent mechanical features.

11

Telescopic reinforced supports

Two telescopic reinforced supports inside the boom, one for fastening to the support flange and the other for the joint between the two booms, 4,100 mm long, making the boom sturdy and safe.



6

2

5

10

7

1

11

9

3

4

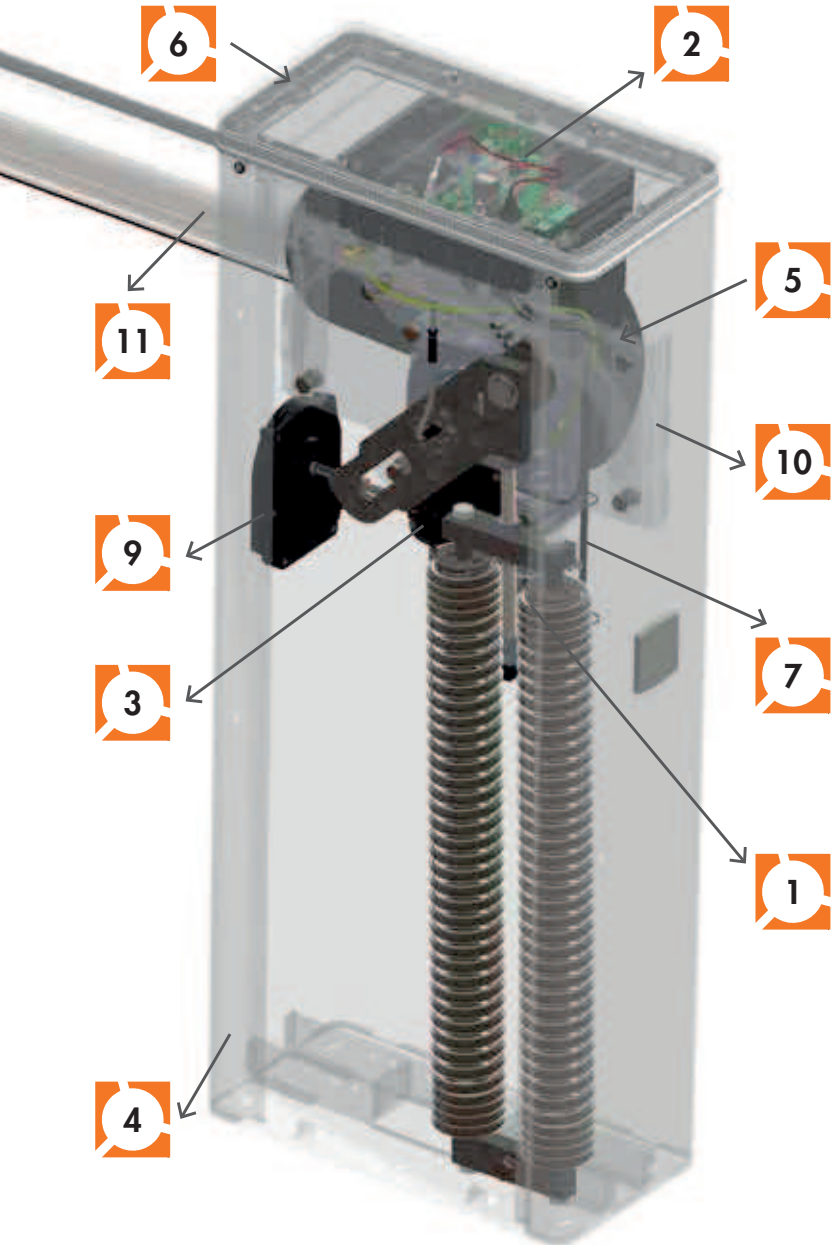

10

New double spring linkage lever

Innovative linkage lever with toothed insert, which guarantees a correct, double and millimetric adjustment of the balancing of the 2 x 85 mm diameter springs. Hooking of the double spring to the linkage lever with roller bearing for a better distribution of the boom load points, weights and stresses.



DIMENSIONS

Note: All measurements in the drawings are in millimetres

BIONIK BI/004

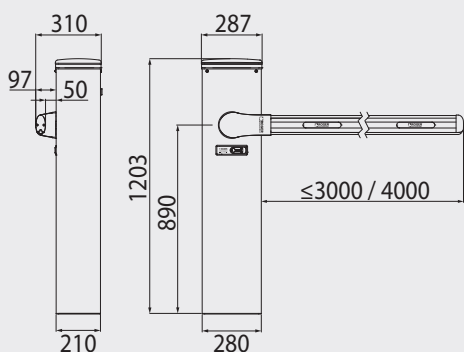

BIONIK BI/001PE - BI/001PC

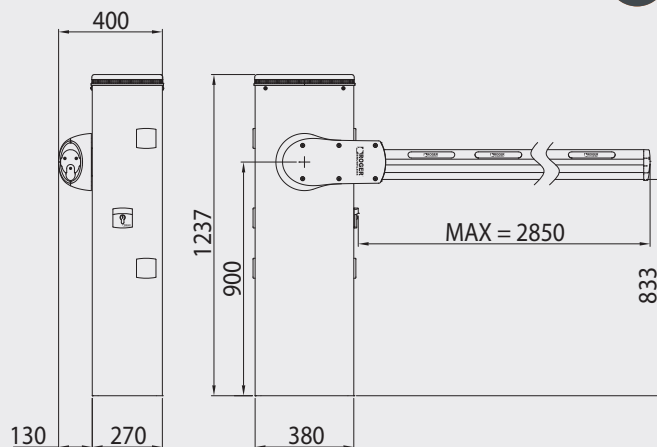

BIONIK BI/004HP

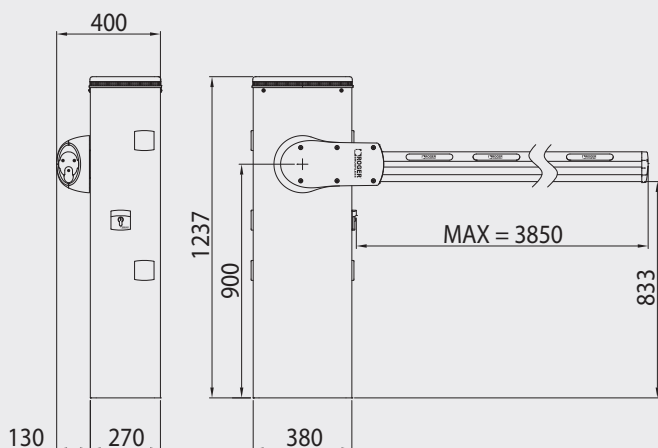



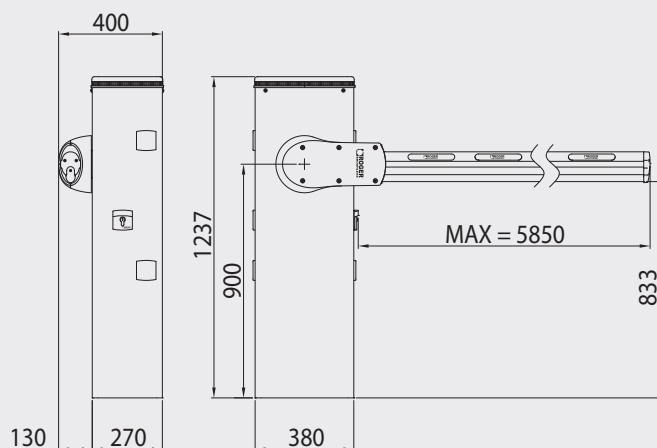

BIONIK BI/006

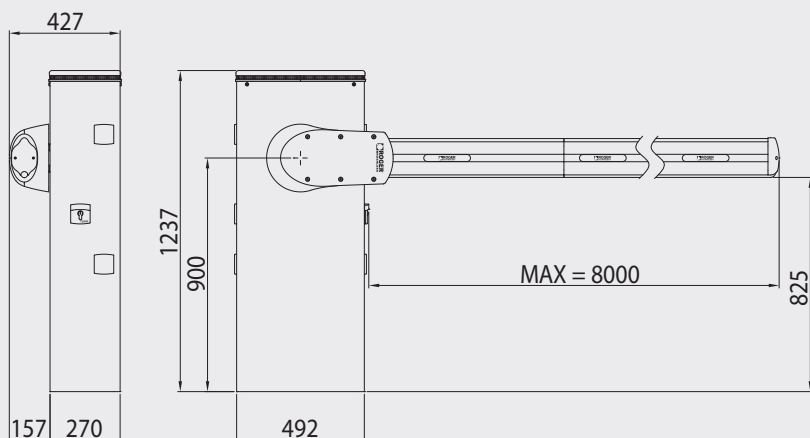

BIONIK BI/008



Technical SPECIFICATIONS

	 BI/004 - BI/004/115	 BI/004HP - BI/004HP/115	BI/006 - BI/006/115	BI/008 - BI/008/115	 BI/001PE	 BI/001PC - BI/001PC/115
Code Description	BRUSHLESS 36V DC Barrier	BRUSHLESS 36V DC Barrier	BRUSHLESS 36V DC Barrier	BRUSHLESS 36V DC Barrier	BRUSHLESS 36V DC Barrier	BRUSHLESS 36V DC Barrier
Boom	up to 4 m	up to 4 m	up to 6 m	up to 8,2 m	up to 3 m	up to 3 m
Line power supply	230V AC - 115V AC 50/60Hz +-10%	230V AC - 115V AC 50/60Hz +-10%	230V AC - 115V AC 50/60Hz +-10%	230V AC - 115V AC 50/60Hz +-10%	230V AC 50/60Hz +-10%	230V AC - 115V AC 50/60Hz +-10%
Brushless motor power supply	36V	36V	36V	36V	36V	36V
Max power	220W	220W	220W	300W	450W	450W
Frequency of use	Continuous	Super Intensive	Super Intensive	Super Intensive	Continuous	Continuous
Operating temperature	-20 +55°C	-20 +55°C	-20 +55°C	-20 +55°C	-20 +55°C	-20 +55°C
Degree of protection	IP54	IP54	IP54	IP54	IP54	IP54
Open time 90°	From 2 to 6 s (with boom up to 3 m) From 3 to 6 s (with boom up to 4 m)	From 3 to 6 s	From 3 to 6 s	From 9 to 29 s	From 2 to 4 s	From 1 to 3 s
Encoder	Absolute digital encoder	Absolute digital encoder	Absolute digital encoder	Absolute digital encoder	Absolute digital encoder	Absolute digital encoder
Typology encoder	Digital SENSORED	Digital SENSORED	Digital SENSORED	Digital SENSORED	Digital SENSORED	Digital SENSORED
Onboard control unit	CTRL	CTRL	CTRL	CTRL	CTRL/P	CTRL/P
Daily operation cycles (open / close - 24 hours non-stop)	5000	5000	5000	2500	8000	12000
Packaged product weight	47 kg	74 kg	74 kg	105 kg	72 kg	87,6 kg
Dimensions	287 x 310 x 1.203 (L x P x H)	380 x 270 x 1237 (L x P x H)	380 x 270 x 1237 (L x P x H)	500 x 270 x 1237 (L x P x H)	380 x 270 x 1237 (L x P x H)	380 x 270 x 1237 (L x P x H)
Release	Handle with a twin-acting elliptical lever and key with a STANDARD cylinder	Release of reduction gear on bearings, with European cylinder key	Release of reduction gear on bearings, with European cylinder key	Release of reduction gear on bearings, with European cylinder key	Release of reduction gear on bearings, with European cylinder key	Release of reduction gear on bearings, with European cylinder key
Number of packages Per pallet	8	6	6	4	6	6

OVERVIEW OF THE BARRIERS

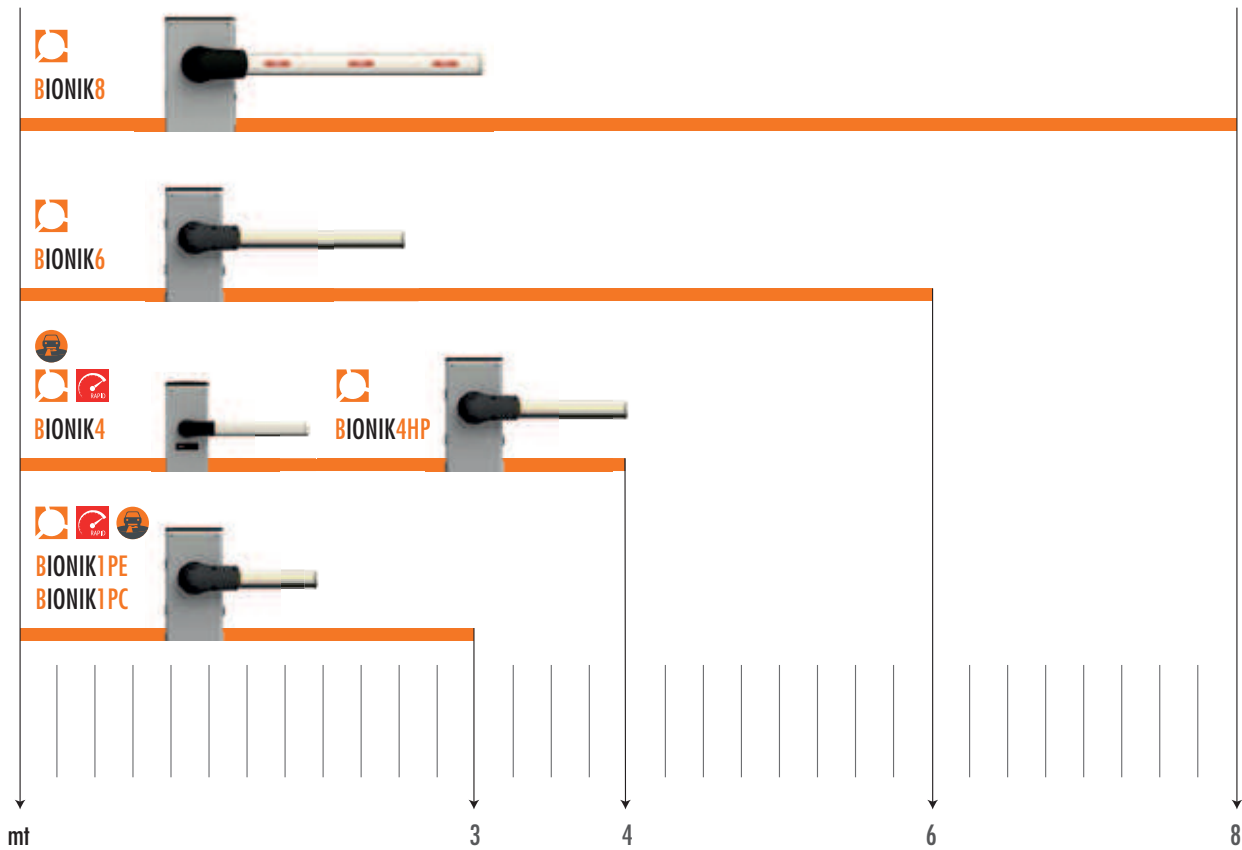

	RESIDENTIAL	COMMERCIAL	INDUSTRIAL	PARKING
BI/004				
BI/004/115				
BI/004HP				
BI/004HP/115				
BI/004HP/IS				
BI/004HP/IS/115				
BI/006				
BI/006/115				
BI/006/IS				
BI/006/IS/115				
BI/001PE				
BI/001PC				
BI/001PC/115				
BIONIK8				